

Action camera

User Manual

FC CE 
Made in China

INTRODCTION

Action Camera is a high-definition digital motion video recording device, created to reach market demand. It has a wide variety of the leading features for digital video recording, photo shooting, audio recording with screen display and detachable battery. Best suitable for vehicle recording, outdoor sports, home security, diving and more related activities. Allowing you to enjoy the moments while capturing every scene anytime, anywhere.

PRODUCT OVERVIEW

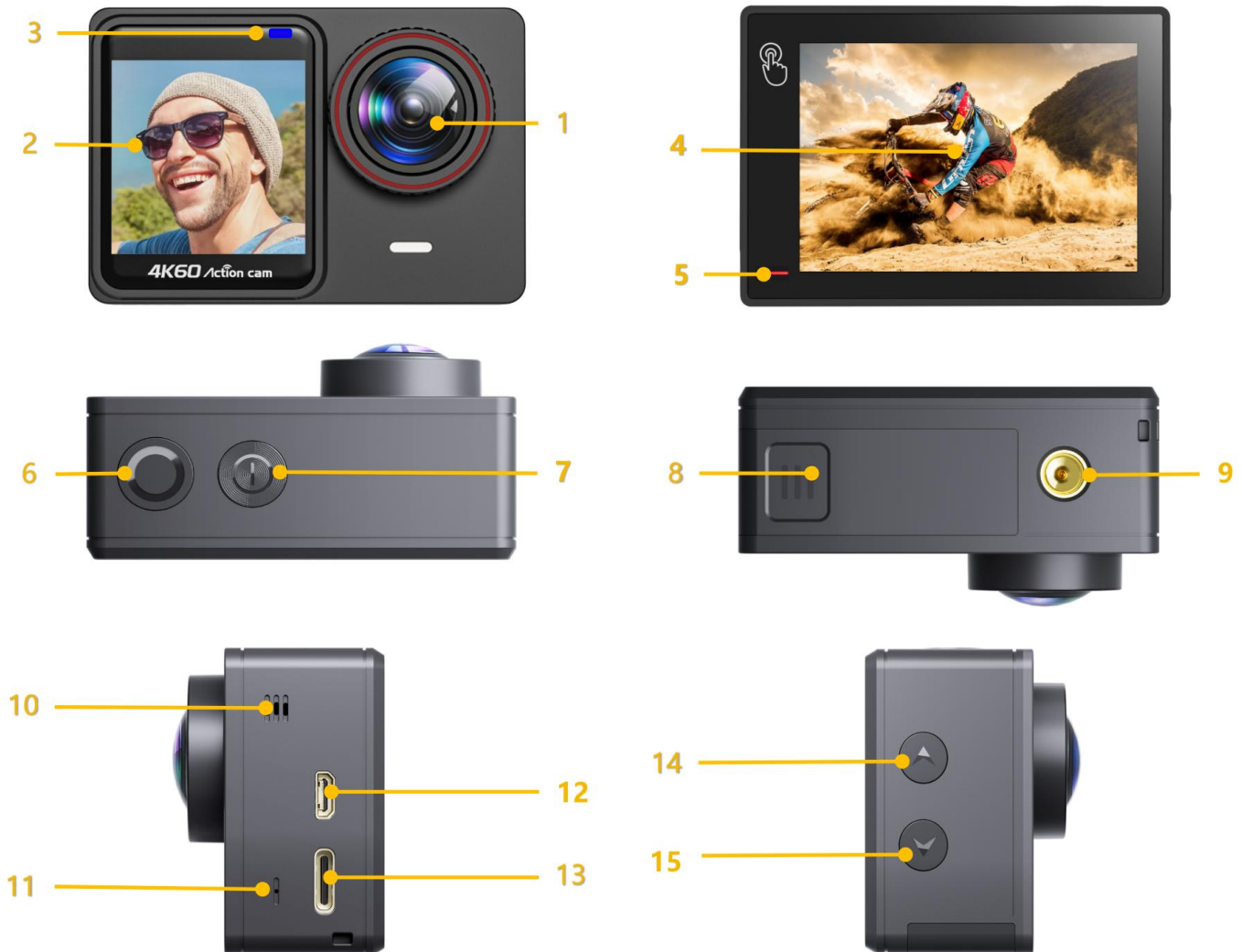

- 1 - Lens
- 2 - 1.4-inch Front Screen
- 3 - Front Screen Working Indicator
- 4 - 2.0-inch Touch Screen
- 5 - Working & Charging Indicator
- 6 - Shutter Button / Select Button
- 7 - Mode Button/ Power Button
- 8 - Battery Door

- 9 - Bracket Hole
- 10 - Speaker
- 11 - Built-in Mic
- 12 - HD Output Port
- 13 - External Mic/Data/Charging Port
- 14 - Up Button / Wi-Fi Button
- 15 - Down Button / Screen Toggle Button /
- Remote Button

Tips:

- Verify the camera is in **Video Mode**, Press and hold the **Up Button** seconds to turn on/off Wi-Fi.
- Verify the camera is in **Video Mode**, press shortly the **Down button** to switch between the front screen or the rear screen to display.

- Verify the camera is in **Video Mode**, press **Down button** for seconds to turn on/off 2.4G remote controller.
- Verify the camera is in **Photo Mode**, Press and hold the **Up Button** or **Down Button** to Zoom in/out photo.

Notes:

- ❖ You can't switch screens during recording or in Setting Mode.
- ❖ Front and rear screens cannot work at the same time.
- ❖ The 1.4-inch front screen has no operation function and is only used for preview.

GETTING STARTED

HELLO

Welcome to your new camera. To capture video and photos, you need a micro SD card (sold separately).

■ STORAGE/MICRO CARDS

We strongly recommend to use the branded memory cards purchased from regular channels for maximum reliability and stability during recording and in high vibration activities.

Use brand name memory cards that meet these requirements:

- micro SD, micro SDHC, or micro SDXC
- **UHS-III rating at least for 4K Video resolution**
(at least 60MB/S or above read and writing speed)
- Capacity up to 128GB (FAT32)

Note:

1. Please format the micro SD card first in this camera before using. To keep your micro SD card in good condition, reformat it on a regular basis. Reformatting erases all of your content, so be sure to offload your photos and videos first.
2. FAT32 format Micro SD card stops recording when the storage of each file is over 4 GB and starts to record again on a new file.

To Power ON: Press and hold the **Power/Mode Button** for seconds to the screen on.

To Power OFF: Press and hold the **Power/Mode Button** for seconds to the screen off.

■ SWITCHING MODE

To Switch Mode:

There are 9 modes: Video, Time Lapse Video, Slow Motion, Short Video, Driving Mode, Driving Mode, Photo, Photo-Time lapse and Burst Photo.

- (1) Turn on the camera, press Mode Button to Mode-Shift Mode, use Up or Down Button to cycle through the various mode, then press Shutter Button to desired mode. To exit, press Mode Button again.
- (2) Turn on the camera, tap Mode icon to Mode-Shift Mode to switch desired mode, as shown below:

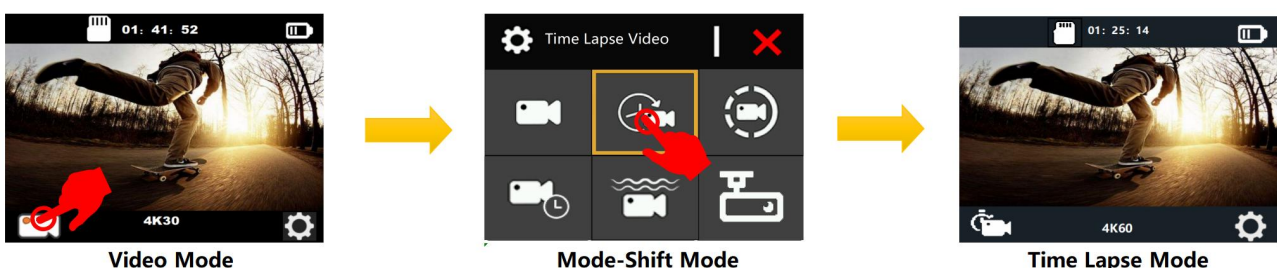

To turn page, please swipe up or down on the screen as shown below:

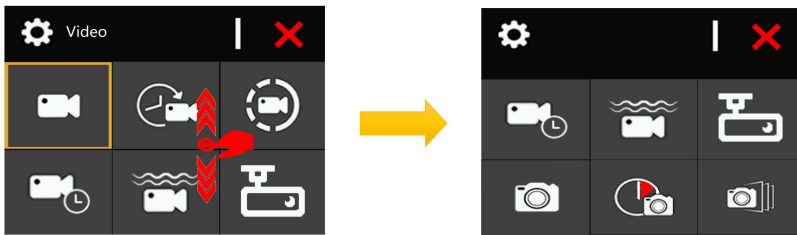

To exit, tap "X" icon.

■ QUICK OPERATION GUIDE

- 1) Verify the camera is in **Video Mode** or **Photo Mode**, quickly **swipe right** on the touch screen to enter **Playback Mode**, as shown below:

To exit **Playback Mode**, quickly **swipe down** on the screen.

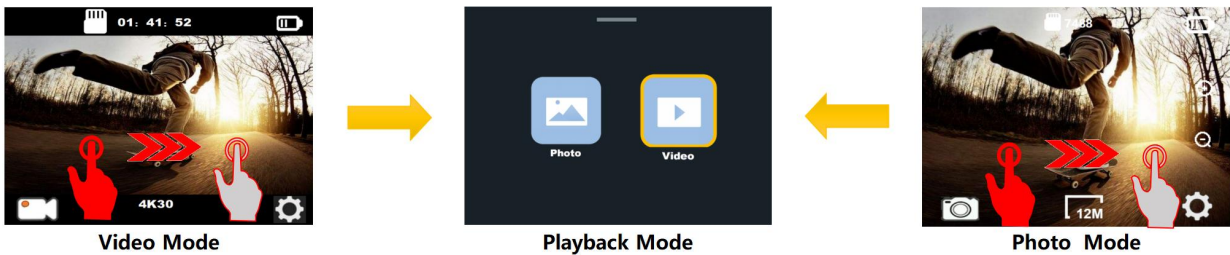

- 2) Verify the camera is in **Video Mode** or **Photo Mode**, quickly **swipe down** on the touch screen to switch to the **Shortcut Mode**, as shown below:

To exit **Shortcut Mode**, quickly **swipe up** on the screen.



- 3) Verify the camera is in **Video Mode** or **Photo Mode**, quickly **swipe up** on the screen to switch to the **Mode Shift Mode**, as shown below:

to exit, tap the icon "X" on the top right corner of the screen

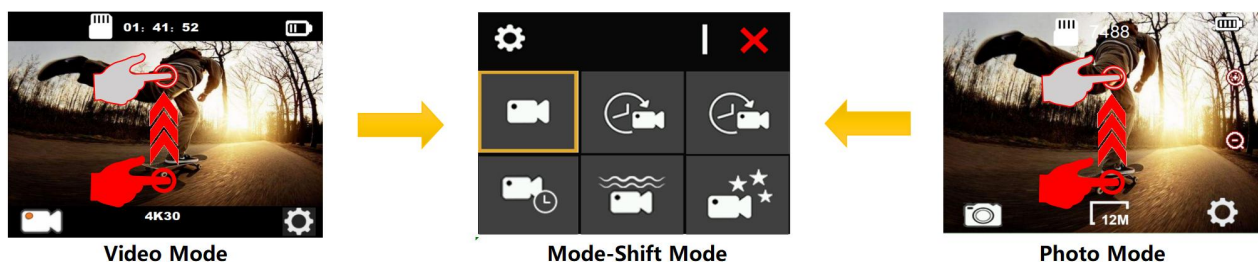

- 4) Verify the camera is in **Video Mode** or **Photo Mode**: **Swipe left** quickly on the touch screen to switch fast to the

Video Settings or **Photo Settings**, as shown below:

to exit, tap “<” icon on the top left corner of the screen

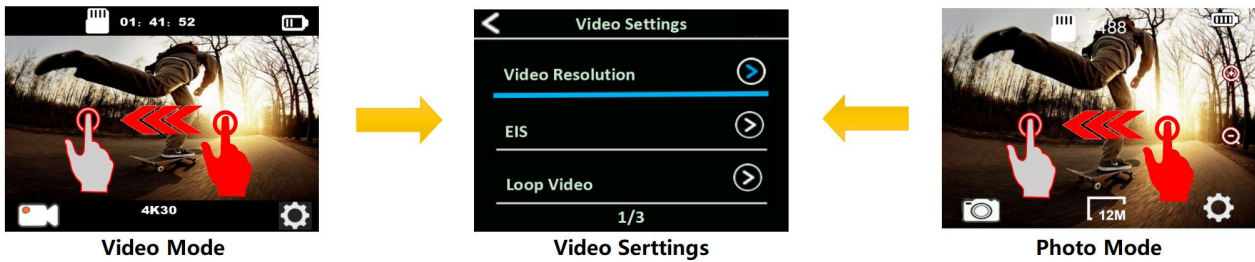

CUSTOMIZING YOUR CAMERA

VIDEO SETTING

Verify the camera is in **Video Mode** or **Photo Mode**, tap the setting icon on the bottom right corner of the screen, then **swipe up or down** to cycle through the various option and tap the desired option, or press **Up Button** or **Down Button** to cycle through the various option and press **Shutter Button** to select the desired option.

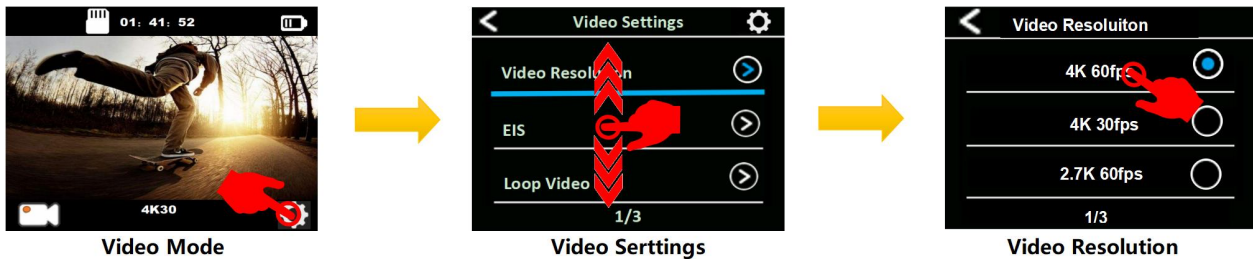

Notes:

- When capturing video at high resolution or high frame rates such as 4K 60/30fps, the camera may become hot and consume more power, which is normal.
- When capturing video at high resolutions or high frame rates in warm ambient temperatures, the camera may become warm and use more power.
- Image Stabilization is disabled when you select 1080P 120fps or 720P 120/240fps.
- If you turn on EIS, Slow Motion, Auto Low Light and LDC will not be available automatically.
- FAT32 format Micro SD card stops recording when the storage of each file is over 4GB and starts to record again on a new file. You cannot set 5min video file length when camera is at 4K 60fps, 5min 4K 60fps video file is over 4GB.
- If you turn on Loop Video, Time-Lapse Video, TL Duration and Slow Motion will not be available automatically.
- If you use this camera as a dash camera, you should turn loop video and driving mode at same time. but save only the latest moments recorded.
- Time Lapse Video is captured without audio.
- If you use Time-Lapse Video function, the camera can not recorded the video over 30fps.
- If you use Time-Lapse Video function, Loop Video, Slow Motion and Fast Motion will not be available automatically.
- If you want to set Time Lapse Duration, please turn on Time Lapse Interval first.
- Please select 1080P 120FPS, 720P 240FPS or 720P 120FPS when you want to record slow motion movie.
- If you use Slow Motion function, EIS, Time-Lapse Video and Fast Motion will not be available automatically.
- Using as a dash cam, we suggest to turn on the Loop Video, Driving Mode and Screen Saver at same time.

PHOTO SETTING

Verify the camera is in **Photo Mode**, tap the setting icon on the bottom right corner of the screen, then **swipe up or down** to cycle through the various option and tap the desired option, or press **Up Button** or **Down Button** to cycle

through the various option and press **Shutter Button** to select the desired option.

In Photo Mode, tag the zoom icon to adjust the zoom level.

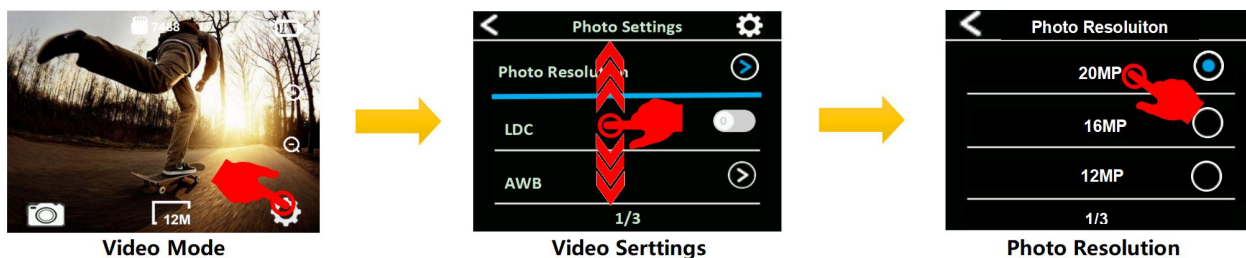

Note:

- If use Long Exposure function, Time Lapse Photo, TL Duration, Burst Photo and Delay Timer will not be available automatically.
- If use Time Lapse Photo function, Burst Photo, Delay Timer and Long Exposure will not be available automatically.
- If you want to use TL Duration, please turn on Time Lapse Photo interval first.
- If use Burst Photo function, Time Lapse Photo, TL Duration and Long Exposure will not be available automatically.
- If use Burst Photo function, Time Lapse Photo, TL Duration and Long Exposure will not be available automatically.

SYSTEM SETTING

Verify the camera is in **Video Settings** or **Photo Settings**, tap the setting icon on the upper right corner of the screen to **System Setting**, then **swipe up or down** to cycle through the various option and tap the desired option, or use **Up Button** or **Down Button** to cycle through the various option and press **Shutter Button** to select the desired option.

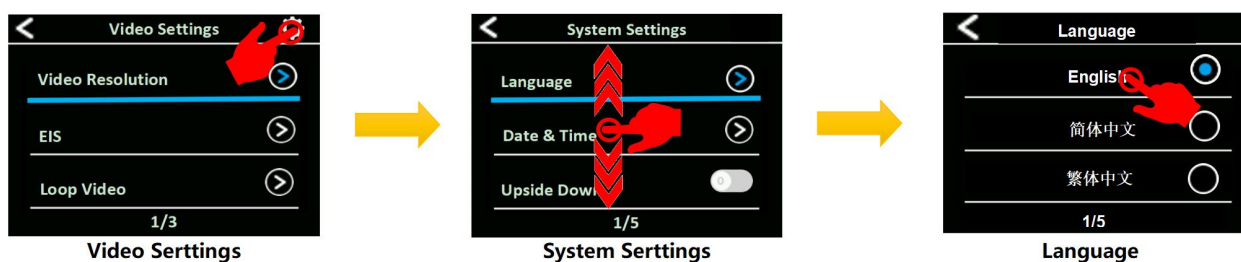

Note:

- Snorkeling mode provides color correction while capturing footage in blue water or clear freshwater at depths of 5 to 33ft (1.5 to 10m)
- Snow mode can suppress overexposure in high-brightness environments such as snow field or beach.
- If the battery is removed from the camera for an extended period of time, the date and time will be reset automatically.
- Software version is the main information of firmware upgrade, troubleshooting and after-sales. If necessary, please provide the software version information to our after-sales team so that we can serve you in time.

VIDEO MODE

To record video, verify the camera is in desired Video Setting option and set the desired video resolution, .

- **To Start Recording:**

To press the **Shutter Button**. The camera' s blue **Working Indicator** will flash and a **Red Dot** will show on the screen while recording.

- **To Stop Recording:**

To press the **Shutter Button** again. The camera **Working Indicator** stop flashing and the **Red Dot** disappear on the

screen to indicate recording has stopped

Notes

- FAT32 format Micro SD card stops recording when the storage of each file is over 4 GB and starts to record again on a new file
- This camera automatically stops recording when the battery is out of power. Your video will be saved before the camera powers off. The video will not be saved, and even the video will be damaged, if the battery is taken out or loses power during recording.
- Due to the battery's characteristics and environmental temperature requirements, such as high temperatures can cause the battery to expand. In high temperature environments, especially in the summer, when you use this camera as a dash camera, we strongly recommend that you remove the battery and use the car power directly, but when the car's engine is turned off, the camera will immediately turn off, the date&time set and last video recorded will not be saved

PHOTO MODE

To capture photo, verify the camera is in desired Photo Setting option and set the desired photo resolution.

- **To capture a photo:**

In the Photo mode, Press the **Shutter Button**. The camera will emit the camera shutter sound.

- **To capture Time-Lapse Photo series**

Verify the camera is selected desired **Time Lapse Photo** mode, Press the **Shutter Button**, The camera will trigger continuous shooting at the set interval and TL duration, the camera will emit shutter sound each time a photo is taken.

To stop **Time Lapse Photo**, Press the **Shutter Button** again.

- **To capture a Burst Photo series:**

Verify the camera is selected desired **Burst Photo** option, Press the **Shutter Button**, the camera will emit shutter sound each time a photo is taken.

- **To capture a Delay Timer Photo:**

Verify the camera is selected desired **Delay Timer** option, Press the **Shutter Button**, the camera initiates countdown and emit shutter sound each time a photo is taken.

- **To capture a Long Exposure Photo:**

Verify the camera is selected desired **Long Exposure** option, Press the **Shutter Button**, the camera initiates BEEP and emit a shutter sound as soon as the photo is taken.

PLAYBACK

You can play back your content on the camera's display, your computer, TV, or smartphone / tablet. You can also play back content by inserting the micro SD card directly into a device, such as a computer or compatible TV. With this method, playback resolution depends on the resolution of the device and its ability to play back that resolution.

■ PLAYING BACK ON CAMERA

1. Enter Video or Photo playback mode. If the SD card contains a lot of content, it might take a minute for it to load.
2. Slide up or down on the screen or press the Up / Down Button to scroll through the video or photo files.
3. Tap the desired file in the file list or press Shutter Button to open video or photo in full-screen view.
4. Tap the screen or press Mode Button to start to playback the video or photo.
Tap the screen again to pause playing back video

- Tap the "Next" or "Previous" icon or press Up or Down Button to switch photo
5. To return to the file list, tap the "return" icon or press Mode Button.
 6. To exit the Playback mode, tap the "return" icon again and slide down on the screen or press Mode Button again.

■ PLAYING BACK ON TV

1. Turn on the TV
2. Connect the Mini HDMI end to the port on camera and HDMI end to HDMI port on the TV
3. Select the right input source on the TV
4. Turn on the camera after a while, you can preview the camera from TV
5. Setting your camera into the video/photo playback mode
6. Select the desired content to playback

Notes:

- If the camera is connected TV with HDMI cable, the camera can not take videos or photos, only for Playback.
- HDMI cable is not included in the standard package, you will need buy an extra HDMI cable.

■ PLAYING BACK ON COMPUTER

To play back your video and photos on a computer, you must first transfer these files to a computer. Transferring also frees up space on your micro SD card for new content. To offload files to a computer using a card reader (sold separately) and your computer's file explorer, connect the card reader to the computer, then insert the micro SD card. You can then transfer files to your computer or delete selected files on your card. Note that you must use a card reader to offload photos or audio files. With this method, playback resolution depends on the resolution of the device and its ability to play back that resolution.

NOTE:

- 4K60 requires a high data transmission stream. If you playback 4K60 video file through a card reader, you may not be able to obtain sound playback. In order to get better playback results, it is strongly recommended to copy the 4K60 video directly to the computer to playback.
- This camera might not be compatible with the files from different solution camera or other device.
- The quick time player is a good compatibility with MOV format video files. We strongly recommend using the Quick Time Player to play back video files on your computer.

■ DELETE FILE ON CAMERA

1. Verify the camera is in Video or Photo Playback menu, If your micro SD card contains a lot of content, it might take a minute for it to load.
2. Slide up or down on the screen or press the **Up** or **Down Button** to locate the file you want to delete.
3. Tap the Delete icon or press and hold the **Up Button** for seconds. The screen shows "Delete File" .
4. Tap the desired option on the screen or Press the **Up** or **Down Button** to locate the desired option: "Single File" or "All Files" , then Press **Shutter Button** to select the desired option.
5. Tap the desired option on the screen to delete the file you want or back the playback list again, or Press the **Up** or **Down Button** to locate the desired option: " Yes / No" .
6. If you select "Yes" , then Press **Shutter Button** to deleted the file you want.
If you select "No" , then Press **Shutter Button** to back the playback mode.

BATTERY

The camera contains sensitive components, including the battery. Avoid exposing your camera to very cold or very hot temperatures. Low or high temperature conditions may temporarily shorten the battery life or cause the camera to temporarily stop working properly. Avoid dramatic changes in temperature or humidity when using the camera, as

condensation may form on or within the camera.

■ BATTERY STORAGE AND HANDLING

- Do not store in temperature above 140°F/60°C.
- Avoid exposing your camera to very cold or very hot temperatures. Low or high temperature conditions may temporarily shorten the battery life or cause the camera to temporarily stop working properly. Avoid dramatic changes in temperature or humidity when using the camera, as condensation may form on or within the camera.
- Do not dry the camera or battery with an external heat source such as a microwave oven or hair dryer.
- Damage to the camera or battery caused by contact with liquid inside the camera is not covered under the warranty.
- Do not store your battery with metal objects, such as coins, keys or necklaces. If the battery terminals come in contact with metal objects, this may cause a fire.
- Do not make any unauthorized alterations to the camera. Doing so may compromise safety, regulatory compliance, performance, and may void the warranty.
- Please do not throw the camera or its battery to the garbage, find a specific recycling point for it.

WARNING:

- Do not drop, disassemble, open, crush, bend, deform, puncture, shred, microwave, incinerate or paint the camera or battery.
- Do not insert foreign objects into the battery opening on the camera.
- Do not use the camera or the battery if it has been damaged - for example, if cracked, punctured or harmed by water. Disassembling or puncturing the battery can cause an explosion or fire.

■ CHARGING THE BATTERY

1. Connect the camera to USB power supply (5V/1A commended).
2. The charging status light remains ON while the battery is charging.
3. The charging status light will turn OFF when the battery is fully charged.

Notes:

- Charging time: 4-hours for 5V 1A power supply
- Please make sure the camera is shuttled down while charging.
- Remove the battery before using as a dash camera and use 5V/1A brand-name car charger.

■ MAXIMIZING BATTERY LIFE

If the battery reaches 0% while recording, the camera saves the file and powers off.

To maximize battery life, follow these guidelines when possible:

- Turn off Wireless Connections
- Capture video at lower frame rates and resolutions
- Use Screen Saver setting.

Wi-Fi APP

The Wi-Fi App lets you control your camera remotely using a smart phone or tablet. Features include full camera control, live preview, playback and sharing of selected content and more.

■ Download and Install FUN DV app

Option 1:

Download the **FUN DV** App or to your smart phone from the Google Play or Apple App Store.

Option 2:

Scan the QR code below to download the **FUN DV** App or to your smart phone.



Android 7.0
or later



iOS 10.0
or later



Notes:

Google, Android, Google play, App Store and other marks are the trademarks of Google LLC.

■ Connect to the Wi-Fi App

1. Press the **Power/Mode Button** to power the camera ON.
2. Verify the camera in video mode: Press the **Up/Wi-Fi Button** for seconds to turn on Wi-Fi, then the Wi-Fi icon and Wi-Fi SSID & password will show on the screen.
3. Connect to the network called "**FUN DV-XXXX**" or "**Action CAM_XXXX**" in your phone 's Wi-Fi setting.
4. Enter the password" 12345678"
5. Launch the **FUN DV** App on your smart phone.
6. Press the **Up/Wi-Fi Button** for seconds again to turn off Wi-Fi.

REMOTE CONTROLLER

Place the Remote Control On Your Wrist and Acquiesce Ultra-convenient Control For Hiking, Biking, Skiing, Bungee and more while installing the camera on your Helmet or other place.

Remote: Splash-proof only / Range: 5M

How to turn on/turn off the remote function:

Select **ON/OFF** in the Setting Menu to turn on/off the remote controller.

Verify the camera is in Video/Photo preview mode first, if the camera is set in Playback or Setting Menu, the camera can not receive the remote signal and can not be controlled by the remote.

■ VIDEO

To start recording:

Press the Grey Video Button.

To stop recording:

Press the Grey Video Button again.

■ PHOTO

To take a photo:

Press the Red Photo Button. The camera will emit a camera shutter sound.

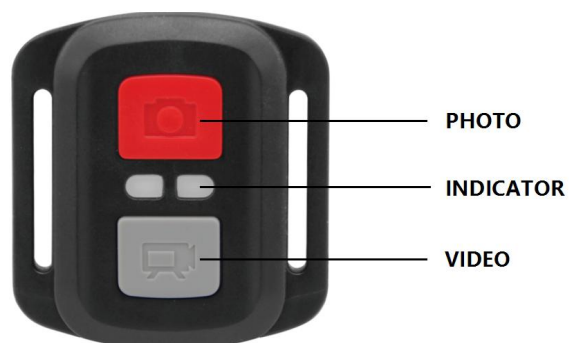

WATERPROOF CASE

Specially designed for diving, surfing, snorkeling and other water sports activities. The waterproof case does not only offer greater waterproof protection to your camera, it also offers extra protection against dust, scratches and shocks. Light and easy to carry, excellent PMMA material endows it with high quality. With the use of the waterproof case, you can record activities even 30M under water and it won't damage the shooting effect, clear and vivid. Your movement and photographic effect won't be affected by anti-surf pressure. Convenient to link camera with other accessories mount through this waterproof case.

■ **HOW TO OPEN:**

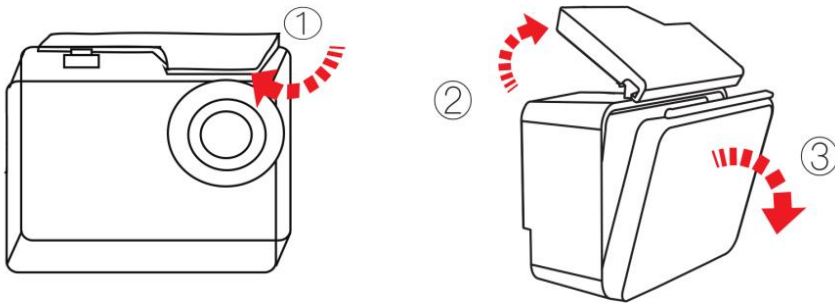

- 1) Pick the black latch up on the top of the case.
- 2) Pull up the buckle of the case.
- 3) Open the back cover of the case.

■ **HOW TO CLOSE:**

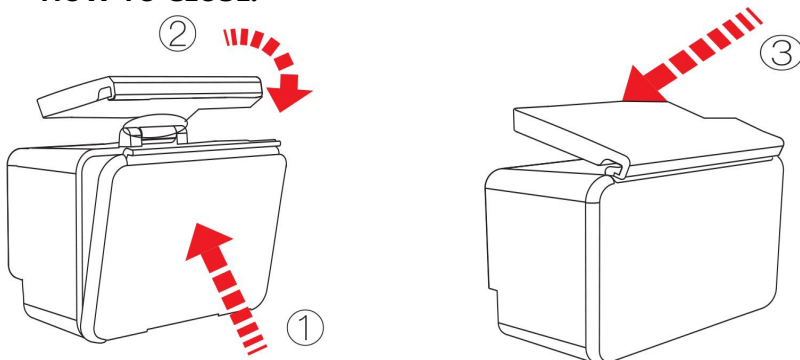

- 1) Please close the back door of the case.
- 2) Pull down the latch and lock it to the back door.
- 3) Press down the buckle.

Tips:

1. Please tear the protective films on the waterproof case lens before shoot/record;
2. To achieve better waterproof performance, the voice record within the waterproof case will be weakened.

NOTES:

- In order to capture a clear video or photo, please tear off the lens protection film of the waterproof shell before use, and protect well the lens window from scratch after use.
- Before sealing the waterproof case, keep the camera housing's White Silicone Seal Ring clean, a single hair or grain of sand cause a leak. You can test by closing the case without inserting the camera. Submerge the case completely in the water for about a minute. Remove the case from the water, dry off its exterior with a towel, and then open the case. If the interior is dry, the case is safe for use under water.
- Before sealing the waterproof case, make sure the waterproof case is sealed well before use. If the white silicone

sealing ring is found to be hardened, deformed or damaged, please stop using this water tank and replace the new waterproof shell in time

- Please dry it in time after use, otherwise the waterproof shell metal button will dust and reduce the waterproof performance. After use in seawater or seaside, you will need to rinse the outside of the housing with fresh water and then dry. This will prevent corrosion of the hinge pin and salt buildup in the seal, which can cause failure. Do not flush the interior with water
- When use the camera with the waterproof in low temperature, such as Winter, Rainy Day, Underwater and so on, please do the anti fogging treatment so as to avoid the blurred video. It is recommended to add anti-fog film; insert the anti-fog film into the waterproof case to prevent the lens from fogging in low temperature or humid environment;
- Keep it safe from falling and dropping and high temperature above 80°C.
- Waterproof shell is vulnerable product, we strongly recommend ,according to the usage of the environment and frequency, to replace the waterproof shell in time.

SAFETY WARNINGS

- This is a 4K action camera, It is normal for the housing to exert heat under use. Don't expose the product directly to high temperatures over 50°C.
- It require a name band Class10 or higher micro SD card,Format your SD card on the camera first before using.
- Keep it safe from falling and dropping.
- Do not place heavy objects on the camera.
- Keep it distance from any strong magnetic interference objects like electrical machine to avoid strong radio waves that might be damaging the product and affect the sound or image quality.
- Keep the camera away from water and liquids (unless equipped with waterproof case). This may cause the the camera to malfunction.
- Don't place your Micro SD card near strong magnetic objects to avoid data error or loss.
- Must remove the battery before using as a dash camera and use brand-name 5v/1A car charger.
- In case of overheating, unwanted smoke or unpleasant smell from the device, unplug it immediately from the power outlet to prevent hazardous fire.
- Keep it safety from children while on charging.
- Do not use the camera when it is low power.
- Do not use or turn off the camera while it is in charging.
- Stored the device in a cool, dry and dust free location.
- Do not attempt to open the case of the camera or modify it in any way,if the camera has been detached,the warranty will be void.

CONTACT US

Specifications are subject to change without prior notice. Please refer to the actual specifications!

For any inquiries, issues or comments concerning our products, please send E-mail to the address below or call us. We will respond as soon as possible.

E-mail: cs@onlincam.com

Web: <https://www.onlincam.com>